

KEY

LANDSCAPE QUALITY

- LOW
- MEDIUM
- HIGH
- UNCLASSIFIED

VISUAL EFFECTS (SIGNIFICANCE)

- SUBSTANTIAL
- MODERATE
- SLIGHT
- NONE (NEGLIGIBLE)
- VISUALLY INTRUSIVE HIGHWAY
- PHOTO VIEWPOINT LOCATIONS

J:\n53213a\Current\M8 Addendum\p101407-.dwg

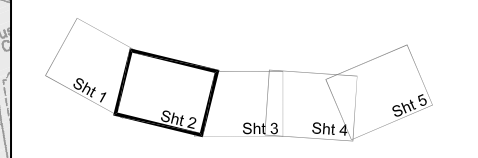

CLIENT



TRANSPORT SCOTLAND

An agency of SCOTTISH EXECUTIVE

PROJECT TITLE

**M8 Baillieston to Newhouse
Updated 2007**

B	Updated 2007	DJH	SH	SWG	JULY 07
A	Scheme Layout Updated	SM	FW	MW	09/02/06
REV	REVISIONS	BY	CHKD	APP'D	DATE
AMENDMENTS					

This map is based on Ordnance Survey material with the permission of Ordnance Survey on behalf of the Controller of Her Majesty's Stationery Office Crown Copyright. Unauthorised reproduction infringes Crown copyright and may lead to prosecution or civil proceedings. Scottish Executive 100020540 Year of publication

DESIGN BY:	CHECKED BY:	FW
DATE:	DATE:	December 05
DRAWN BY:	APPROVED BY:	MW
DATE:	DATE:	December 05

DRAFT FINAL REPORT

ENGINEER

Mouchel FAIRHURST

IN ASSOCIATION WITH

SIAS 

DRAWING TITLE

**M8
Addendum: Landscape Effects
Landscape Quality
(Sheet 2 of 5)**

SCALE 1:10,000 AT A3

DRAWING NO **Figure 11.3b**

REV **B**